

# cap(coder)

Specialists in Filling & Capping

## Delta Fill

Highly Accurate Bench Top  
Touch Screen Filler.



12 Bottles  
Per Minute\*



### Optional Equipment

- ✓ Foot Switch available boosting ease of use.
- Our Multi-Link System
- ✓ allowing you to use multiple Delta Fills as slaves and one as a master. Allowing control over multiple units from a single interface.
- ✓ Stainless Steel Mounting Table



### Liquid Dispensing

- ✓ 0.5% Accuracy\*
- ✓ Gear or peristaltic fillers available.
- ✓ Up to 10ltrs/pm\*\*
- ✓ Suitable for most liquids.
- ✓ Quick change filler nozzles.
- ✓ Shut off nozzle available.
- ✓ Built using 316 grade stainless steel.



### Touchscreen Operated ✓

Our Delta Fill is operated by touchscreen, allowing ease of use. Additionally allows you to save settings for each fill type.



Contact Details:  
Telephone: +44 (0)1865 891466  
Email: [sales@capcoder.com](mailto:sales@capcoder.com)

**MADE IN  
BRITAIN**

Cap Coder Ltd, 42 Monument Business Park, Warpsgrove lane, Chalgrove, Oxon, OX44 7RW  
Company No: 02101507 VAT No: GB285 1533 52.

# Technical Specifications

## Delta Fill

Highly Accurate Bench Top  
Touch Screen Filler.

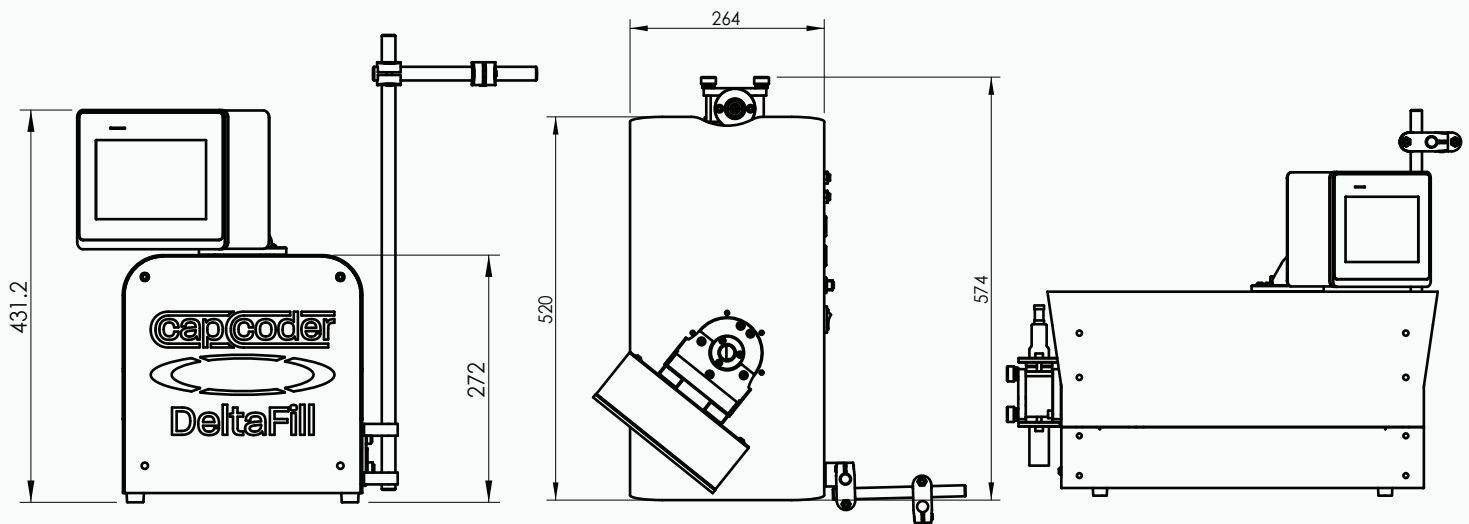

### Dimensions & Construction

Dimensions	264mm(w) x 574mm(d) x 431mm(h) – without any optional extras
Weight	30Kg – without any optional extras.
Build Standard	UKCA or CE Certification. IP65 Rated

Machine Construction	Aluminium internal frame, with aluminium base. Clad with folded stainless steel panels.
	Swivel HMI Enclosure, constructed of stainless steel.

### Machine Options

Pumps	1.5ltr, 6ltr, 10ltr, 17ltr Gear Pump 3:1 Gear Box DY15, DY25 Peristaltic Pump
Other Options	Foot Switch Multi-Link System for connecting multiple slave units to one master. Stainless Steel Mounting Table

### Electrical Information

Supply	230v Single phase, supplied via BS 1363 13A Plug*
Consumption	1.1kW
Controls	Schneider PLC as standard

\*Supplied via "D" rated MCB, not RCD.

### Pneumatic Information\*

Supply Size	8mm
Supply Pressure	5 Bar
Consumption	Notionally 1-2 Litre/Min

\*Only required for pneumatic shut off nozzle.

### Warranty Information



All our machines are covered by a 12 month parts & labour warranty, covering your machine in the unlikely event you have a problem.

For full terms and conditions please see our website.

Want to see the  
Delta Fill  
in action?



\*Accuracy is theoretical and dependant on many conditions.

\*\*Representative value, actual amount may vary and is dependant on trials.



Contact Details:

Telephone: +44 (0)1865 891466

Email: [sales@capcoder.com](mailto:sales@capcoder.com)

